

Simple/Reliable/Green/Efficient

大牧人
Big Herdsman



BREEDER CAGE - BH1250

The BH1250 breeder cage system is designed to meet high standards for egg fertilization rates and breeding conditions. The 4.8-meter large-tier stacked structure integrates automated egg collection, feeding, watering, manure cleaning, lighting, environmental control, and IoT modules, ensuring breeder welfare and efficient production.



WEBSITE

✉ bigherdsman@bigherdsman.com



EGG PRODUCTION

Technical Description

- **Large-Tier Design:** Sturdy structure with ample space, promoting breeder welfare and high fertilization rates.
- **Efficient Egg Collection:** Stable operation with low egg breakage rates and high automation.
- **Clean Water Supply:** Filters ensure water quality, with 16 nipples per cage providing ample water.
- **Corrosion-Resistant Cleaning System:** Ensures clean manure belts for a hygienic environment.
- **Smart Environment Control:** Fully automated systems monitor and adjust conditions, reducing mortality and improving fertilization rates.
- **Roosting Perches:** Designed for breeders' habits, enhancing egg fertilization.



Item	Parameters (mm)
Group interval	4824
Floor height	830
Systematic width (L1)	1600
Column width (L2)	1250
External height of cage (H1)	700
Internal height of cage (H2)	630
Height of door	500

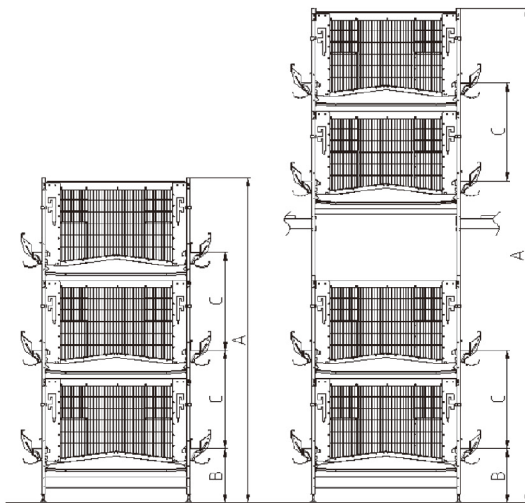
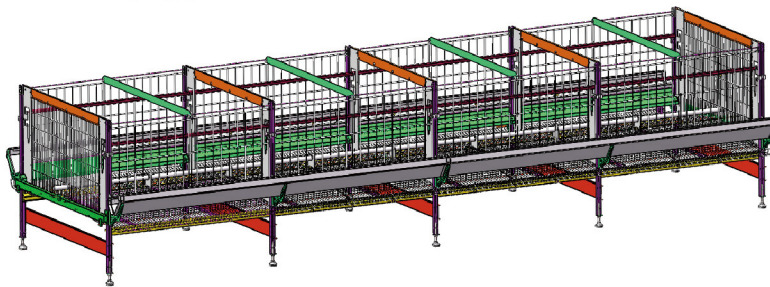

**Cage for layer breeder
with natural service mode (chain feeding)**

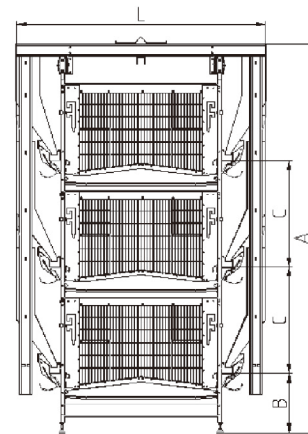

**Cage for laying breeder chicken
with natural service mode (hopper feeding)**



BIG HERDSMAN MACHINERY(JIAOZHOU) CO.,LTD

Add: Shangde Avenue and Huanghe Road Intersection, Jiaozhou Economic and Technological Development Zone, Qingdao City, Shandong Province, China
Tel: +86-532-6696 2297 / +86-532-5850 3988
Website: www.bigherdsman.com



SCAN QR CODE ON WECHAT